

**COMPUTER HARNESS**

- C1. Engine Control Module (ECM)
- C2. Data Link Connector (DLC)
- C3. Malfunction Indicator Light (MIL)
- C4. ECM Harness Connectors (3)
- C5. ECM Harness Ground
- C6. Dash Fuse Box
- C7. Electronic Ignition Ground
- C8. ECM Main Relay
- C9. Fuel Pump Fuse (15-Amp.)
- C11. Oxygen Heater Fuse (10-Amp.)
- C12. ECM Main Fusible Link (30-Amp.)

**CONTROLLED DEVICES**

- 1. Fuel Injector
- 2. Idle Air Control (IAC) Valve
- 3. Fuel Pump Relay
- 6. Electronic Ignition (EI) Assembly
- 6a. Ignition Coils
- 12. EGR VSV
- 13. Heater-A/C Relay
- 14. Canister Purge VSV

**INFORMATION SENSORS**

- A. Manifold Absolute Pressure (MAP) Sensor
- B. Heated Oxygen Sensor (HO2S)
- C. Throttle Position (TP) Sensor
- D. Engine Coolant Temperature (ECT) Sensor
- E. Intake Air Temperature (IAT) Sensor
- F. Vehicle Speed Sensor (VSS)
- K. Power Steering Pressure (PSP) Switch

**EMISSIONS SYSTEMS (NOT ECM CONTROLLED)**

- N1. PCV Valve
  - N2. EGR Valve Back Pressure Transducer
  - N3. Spark Plugs
  - N4. Fuel Rail Test Fitting  
(For Fuel Pressure Test)
  - N5. Crankshaft Position (CKP) Sensor
  - N15. EVAP Canister
- \*Fuse/Relay Box

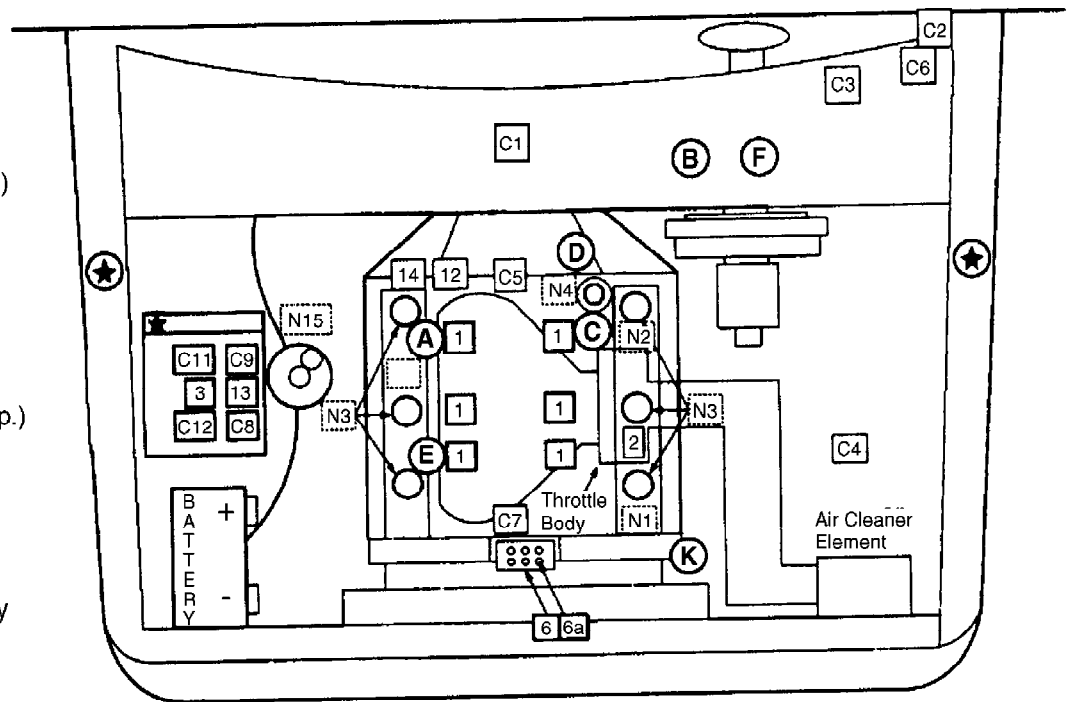

**3.2L 1995**